

Lesley University

DigitalCommons@Lesley

Lesley Review

Special Collections and Archives

Summer 1969

Lesley Review (Summer 1969)

Lesley College

Follow this and additional works at: https://digitalcommons.lesley.edu/lesley_alumnae

Recommended Citation

Lesley College, "Lesley Review (Summer 1969)" (1969). *Lesley Review*. 15.
https://digitalcommons.lesley.edu/lesley_alumnae/15

This Book is brought to you for free and open access by the Special Collections and Archives at DigitalCommons@Lesley. It has been accepted for inclusion in Lesley Review by an authorized administrator of DigitalCommons@Lesley. For more information, please contact digitalcommons@lesley.edu, cvrattos@lesley.edu.

LESLEY ALUMNAE REVIEW • SUMMER/FALL 1969



EDITOR

James A. Hiltz

**LESLEY COLLEGE ALUMNAE
ASSOCIATION BOARD**

Lorraine Blondes Shapiro '42
President

Barbara Barron Schilling '50
1st Vice President

Marilyn Beach G '67
2nd Vice President

Marilyn English Riley '59
Treasurer

Joyce Marshall Snyder '61
Secretary

BOARD OF DIRECTORS

Term Expiring 1970

Gail Roberts Dusseault '60
Joanne Lipsher Goodman '66
Jean Cogan McKeon '52

Term Expiring 1971

Polly Wilson Connell '26
Winifred Linehan G '55, G '57
Eileen O'Leary O'Loughlin '39

Term Expiring 1972

Marguerite Shamon Delany '50
Eileen E. MacElarney '53, G '56
Mary McCarron Mead '25

MEMBERS EX-OFFICIO

Adele Gruener '20
Dr. Leslie M. Oliver
Doris Kimball Newman '31

LESLEY ALUMNAE REVIEW • SUMMER/FALL 1969

The Changing Admissions Scene	2
New Campus Happenings	7
Around the Campus	9
Annual Report of the Alumnae Association	11
Introducing Lorraine B. Shapiro, Alumnae President	13
This is the Year!	14
Club Notes	15
Class Notes	16



College testing is not without its effect. In recent years, Lesley has moved into a "rolling admissions" kind of a situation due to earlier testing by the College Entrance Examination Board. When a candidate's testing is completed and her folder of information is compiled, she may be reviewed by the Admissions Committee quite early in the year. Many candidates are now notified of their admissions standing as early as January preceding their freshman year.

One aspect of the makeup of today's students was illustrated earlier when their commitment to service was discussed. There is yet another segment in the makeup of today's student that has a powerful effect on admissions and, eventually, entire campuses.

Today's college student — at Lesley or any other campus — demands a greater share in decision-making in the community. She wants a voice in all issues and, at the very least, she requires a sincere hearing on matters that affect her and fellow students. Current demands of students have forced many colleges to test out ways to best utilize student expertise and to become more sensitive to their student bodies.

Lesley students have contributed a great deal to current programs on the campus. They include curriculum changes, student membership on major college committees, representation on governing boards. In addition, students are seen in new roles such as resident fellows, sponsors of all-college meetings, and weekend human relations conferences, and assessors of the function and activities of Lesley's Student Government.

The recent high school graduate is not the only student who has changed the complexion of admissions offices across the country. A further elasticity has developed with the increasing enrollment of older women, former college dropouts, young married women and women from academic as well as social minority groups, particularly the black population of our country. There is much new thinking presently underway concerning college admissions practices for groups of this nature.

In the past year, Lesley was directly represented at twelve conferences on disadvantaged people. In addition, the Office of Admissions sponsored its own conference for 22 Boston area colleges and Upward Bound organizations. Some of the information gathered from activities of this nature was reflected in a set of guidelines developed by the Lesley Office of Admissions for the admission and financing of minority groups. This was passed as a resolution by the Board of Trustees last December.

Lesley's admissions staff was also busy initiating new contacts and reaffirming old contacts with local and national agencies who could aid the College in recruiting, screening and admitting students from minority groups, with an emphasis on black students.



As more students from non-traditional backgrounds seek admission to Lesley and other colleges, admissions officers will be faced with a growing challenge to seek new ways in which to measure "admissions" readiness. Lesley's "Guidelines for the Disadvantaged" is one such measurement that could be readily adapted to suit the needs of a variety of groups. There are other measurements that can be of tremendous help to these students who want to further their education.

CLEP (College Level Examination Program), for instance, was developed by the College Entrance Examination Board. This is designed to measure the non-affiliated student's preparation for college and to determine the level at which the student should begin a program of higher education. Utilizing CLEP measurement, education gained through correspondence courses, job exposures, one's own life experiences, independent reading, could result in "advanced standing" without formal college background.

SIGI (System of Interactive Guidance and Information), devised by the Educational Service, is narrower in its scope but, nevertheless, an important means of determining the overall qualities of potential college students. The system utilizes computer techniques to match junior college students with career possibilities, thus aiding in the selection of colleges with appropriate programs for students' career objectives.

In considering factors contributing to the increasing fluidity found in admissions work, reference must, indeed, be made to the increasing volume of students who transfer from one college to another. Within the frame of reference of previous college experience, the transfer student is more education-minded, credit-conscious, and critical of curriculum. The admissions staff of this College is not immune to prodding by the transfer student who seeks more adequate ways to correlate student teaching and education courses, and who also wants fair alternatives and substitutes in General Education studies.

Money, of course, always has and always will be an influence on admissions practices. But in recent years, the role of the dollar has become significantly wider in scope because of its source.

The prime source of revenue for Lesley and other similar institutions is income from student enrollment. There must be a sufficient number of paying students in order to provide funds for the College to operate. There must also, however, be adequate funds to attract students — talented, disadvantaged or otherwise — who cannot underwrite the cost of a private college education. At the present time, 72% of all financial aid to Lesley students is out-of-pocket. The remaining 28% must come from new sources. The largest amount of outside funds come from federal funds, through Lesley's participation in NDEA (National Defense Education Act) for which the College contributes one-ninth of the total monies; and EOG (Education Opportunity Grant) in which all monies are matched in full by funds from the College. Acceptance of federal funds, however, implies silent consent to comply with policies governing the dispersment of these funds.

There is a final factor in the changing admissions scene and, to this writer, it is perhaps all-important.

This is the college environment itself. The aura of a school has, perhaps, even greater impact on admissions than all other factors together. It is a fact that 82% of all college-bound students go to a college in their home state; that almost all of them choose a college with a student body similar to themselves.

Because of this very strong influence, Lesley and other colleges must continuously survey themselves and answer these questions: What is the college really like? How does the college see itself? What types of students are attracted to the college? Are the programs special?

Of course, a college such as Lesley must ask additional questions: "Is Lesley's goal of a pluralistic student body realistic? Can Lesley be a genuine "Laboratory for Learning?" These questions must be answered in the light of current enrollment statistics on college-bound youth. Of the 42% who will choose to major in Education, how many will be young women who want to attend a small, female, private, urban, expensive, Massachusetts teachers college offering a program in elementary education, and having a human-relations/behavioral sciences oriented philosophy?

One of the ways in which answers to questions of this nature will be sought at Lesley in the coming year is through the establishment of an ad hoc advisory admissions committee of students and faculty. These people will work closely with the admissions staff and the regular admissions committee during the year in order to glean additional perspective into tasks facing admissions officers.

Other projects under consideration by the Office of Admissions is a special admissions seminar in Lesley's Experimental College, a volunteer, free-wheeling type of evening program available to all who wish to participate. It is also feasible that an open "admissions table" will be set up in the cafeteria during luncheons for students who want to engage in discussions concerning admissions and other factors relating to the College.

This has been merely a glimpse of the changing scene in admissions work, and Lesley does not have a monopoly on the factors that have been discussed. Every institution of higher education is faced with very similar situations, in addition to those factors that are peculiar to each individual institution.

Martina B. Ackerson



New Campus Happenings ...

Lesley Launches Campus Building Program



Mr. Ervin Pietz, Chairman of the Steering Committee for the Lesley College Building Program.

A \$15 million campus development program was announced formally at the Annual Corporation Dinner on October 30, bringing to fruition many years of new campus planning. At the same time a "Million Dollar Campaign" was launched to complete the financing of the First Phase construction.

Construction will begin during 1970 on the First Phase which will cost approximately \$4 million. Of this amount, the college now has a federal grant of \$750,000 plus \$2.25 million in low-interest loans.

More than 600 persons attended the gala dinner at the Hotel Continental, including about 100 alumnae campaign committeemen, the governing boards of the college, leading parents, the faculty and students.

Mr. Ervin Pietz, Trustee and chairman of the Steering Committee for the Building Program, explained that campaign workers will be seeking three-year pledges from all members of the college's governing boards, alumnae and parents, and gifts from foundations and corporations. The following goals were established:

Governing Boards	\$ 450,000
Alumnae	100,000
Parents	150,000
Foundations, Corporations, Friends & Bequests	300,000
	<u>\$1,000,000</u>

Mary McCarron Mead '25 represents the alumnae on the Steering Committee.

Commemorative Gift Opportunities

The tradition of commemorating in perpetuity the names of those who have shown faith in education and who have made outstanding contributions to the advancement of knowledge is older than our nation.

At Lesley College, plaques commemorating the founder, her family and others — trustees, alumnae, parents and great teachers — mark the

memory of those who gave their efforts or their resources to insure continuation and growth in education at Lesley.

Commemorative gift opportunities are available to those who would like to link a family name with Lesley's new campus. Please contact the President, the Chairman or any member of the Board of Trustees, or a member of the staff of the Development Office.

Alumnae Praise New Campus Plans

The new Campus plans described in the last issue of the *Alumnae Review* . . . evoked enthusiastic praise from Lesley Alumnae. In response to a questionnaire, several hundred alumnae of all ages gave their endorsement and many offered assistance in any forthcoming fund-raising efforts.

Typical of the comments received were:

"Fantastic!"

"Bold and progressive . . ."

"Gives me a sense of pride in being a Lesley alumna."



This Could Be The Start of Something . . . Big?

Construction workers recently made an appearance on the campus to take "core" samples of the soil underneath. Purpose is to determine the kind of foundation needed for the First Phase.

Ground-Breaking Target is Spring, 1970

Bids for the First Phase of construction are expected to be received during the winter months with actual construction to begin in the spring.

The First Phase will build approximately one third of the proposed \$15 million campus, and will involve redevelopment of the area between White Hall and Mellen Street (See Plot Plan). White Hall, the Administration Building and Stebbins Hall will remain unchanged. Three of four multi-purpose buildings will be located on Oxford Street, with the fourth on the opposite side of the plaza or mall beside the new library.

In keeping with the concept of the whole campus as an urban academic village, and with the College's "laboratory" philosophy toward education, the First Phase will include instructional, social, housing and service areas. This will provide maximum opportunity for interaction between faculty, students and administration.

Located on the main level of the Oxford Street side will be a lecture hall for 200 students, a conference room, the Admissions offices, and two bays of student services including a coffee shop, laundry pick-up and bookstore. Across the mall will be the entrance level of the library.

Under the central portion of the mall is planned the needed space for mechanical equipment, service and receiving, and parking. The library's curriculum lab and audio-visual room also will be located on the lower level. Along Oxford Street will be the science and music classrooms.

The second level includes two classroom suites, open seminar areas, a faculty office suite, the periodical area of the library and the first floor of a house unit.

The third, fourth and fifth levels will contain additional library facilities and four house units. Each three level house unit is designed to include a residence director's apartment, lounge and study areas and single and double rooms for 36 students.

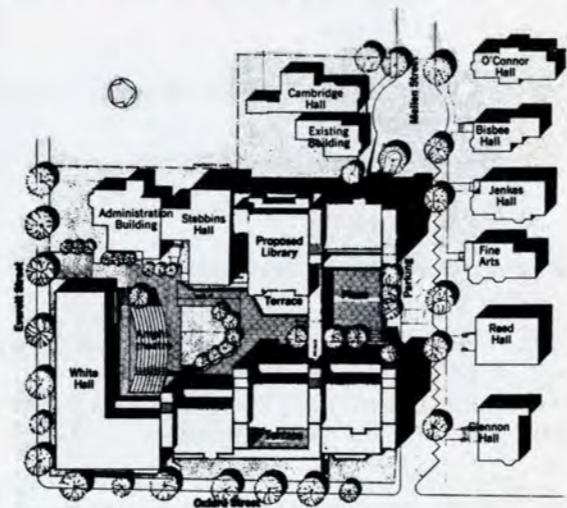

First Phase Plot Plan

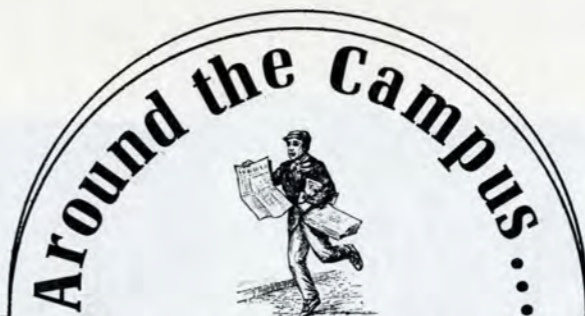

Dr. George L. Miller has been appointed vice president for academic affairs by the Lesley College Board of Trustees. In his new assignment, Dr. Miller will be responsible for the continuing development and implementation of academic programs on the undergraduate and graduate levels, and for Lesley's Schools for Children. Dr. Miller will also continue his work as Dean of Teacher Education.

Mr. John Tucker has been appointed vice president for financial affairs. In announcing his appointment, the Board of Trustees indicated that Mr. Tucker will handle all financial functions and transactions for Lesley College. Mr. Tucker came to Lesley 4 years ago as treasurer.

Dr. Boris Gertz, Director of the Graduate and Extension Division, ran a successful Summer School Program this year in cooperation with the Winchester Public School System. Much of the work included direct learning experiences within the Winchester System.

A number of special events took place at Lesley College during the past year. They included a lecture by David Schoenbrun, internationally acclaimed news correspondent, who spoke on "The Kennedy Years and After", and Margaret Mead, famed Cultural Anthropologist who paid a special visit to Lesley. Other well known personalities on campus during the past year included Thomas Atkins, a well known figure in Boston politics, and Melvin Miller, dynamic young editor and publisher of the "Bay State Banner," a leading news publication in Boston's black community.

NEW ENGLAND KINDERGARTEN CONFERENCE

The Lesley-sponsored New England Kindergarten Conference continues to grow. A record attendance of 1,200-plus educators were at the conference in November. Dr. Leland B. Jacobs, of Teachers College at Columbia University, delivered the keynote address at the day-long meeting. **Mrs. Mary B. Mindess**, Associate Professor of Early Childhood Education at Lesley, was chairman of the event. This year's conference will be held in Boston on November 21st. Further information will be available to all Lesley Alumnae.





Homecoming '69 was pure success, as may be evidenced from the faces of some "fifty-niners" during the dinner in White Hall.



Reminiscing was in order during the annual show at Parents' Weekend. Girls reflected on college life in a revue entitled "Those Were the Days."



Margaret Mead was surrounded by students, faculty, and visitors as they engaged in lively conversation during the famed anthropologist's visit to Lesley.



Sanders Theatre was filled with happy faces and the laughter of young children who thrilled to the music and fun when Tony Saletan, noted children's folk singer, presented "Sing Children Sing!" The event was sponsored by the Lesley College Alumnae Association.



Dr. Samuel A. Kirk, noted educator (center), goes over program with Mr. Floyd L. Benitz, Director of the Lesley College Schools for Children (left) and Dr. Elmer E. Van Egmond, Dean of General Education. Dr. Kirk presented the Commencement Address and had bestowed upon him the honorary degree of Doctor of Humane Letters during Lesley's commencement exercises in May.



Annual Report of the Alumnae Association

Janet M. Silva G '58

President, Lesley College Alumnae Association 1968-69

The moment has come to make an accounting for my stewardship as President of the Alumnae Association for 1968-1969. I feel that we have progressed toward a more cohesive and active alumnae body. There have also been some notable firsts chaired by capable Directors of the Board during this year.

Our first event, "Up the Down Staircase" planned by Marilyn Beach G '67 and Joyce Marshall Snyder '61 of the Continuing Education Committee for December 12, 1968, involved alumnae professionals from various representative Massachusetts school systems. The alumnae volunteers contribute their time and talent by providing counsel and information concerning their particular systems to members of the Class of 1969 who were preparing for job interviews.

The second "first", chaired by Joyce Marshall Snyder '61 on May 17, 1969, at Sanders Theatre in Cambridge, was "Sing, Children, Sing", a presentation by Channel 2 children's folk singer, Tony Saletan. This program was specifically geared to younger alumnae and their children. One special feature, oriented toward community service, was the donation of complimentary tickets purchased by alumnae and friends to local settlement house groups. Treasurer of the Association, Marguerite Shamon Delany '50, greatly aided Joyce in the handling of finances for the program.

Lastly in the chain of firsts was a "Dial-a-thon" telephone campaign organized by Lorraine Blondes Shapiro '42 and Eileen MacElarney '53 and held on May 1, 5, 6 under the auspices of the Annual Giving Program.

A basic part of the Association offering for 1968-1969 was the ongoing core of programs. "Step-Up Night" on May 6, 1969, chaired by Gail Roberts Dusseault '60, who who was assisted in her efforts by Joyce Karp Rosenthal '60, took on a new dimension. It was held in White Hall with all participants in academic dress. We feel that the tone of quiet reflection and emotion was a significant step towards resurrecting a lovely tradition at Lesley.

On May 3, 1969, the Scholarship Committee met under the direction of Marguerite Shamon Delany '50 to interview candidates for the Gertrude Malloch Alumnae Award. Lively group interviews proved of interest to both committeemen and applicants. Miss Ellin Leventhal '70 was chosen recipient of the Award and attended Homecoming on June 7 for its presentation at the Annual Association Meeting. Her gracious acceptance speech pleased all present.

"Homecoming '69" was chaired effectively by Myrtle Peirce Aulenback '39, Eileen O'Leary O'Loughlin '39 and Geraldine Nye Pedrini '63. A special effort was made this year to provide both full daytime and evening programs in order to meet the needs of various alumnae. The morning program was initiated with the Annual Association Meeting. Early afternoon brought brilliant sunshine and a lovely buffet luncheon. Following the luncheon, alumnae chuckled at the clever sketches of cartoonist Roger Palmquist who penciled round the theme: "Be Glad You're a Gal."

Evening festivities included a Champagne Reception, prime rib of beef dinner and dancing to Ken Reeves and his orchestra. Highlights were the slide presentation and address by Neill Smith, architect for the projected new campus and the presentation of the Alumnae Award to the Board of Trustees, represented by Mr. Ervin Pietz, Chairman of the Steering Committee for the Lesley College Building Program.

The Club System functioned under the able guidance of *Jean Cogan McKeon '52*, *Marilyn English Riley '59* and *Barbara Barron Schilling '50*. A concentrated drive was made this year to send a board officer or director to at least one meeting per area club during the year.

Miss Adele Gruener '20 continued as custodian of our archives. Several interesting pieces have been discovered including the original stained wood "Lesley School" sign.

Mrs. Doris Kimball Newman '31 has performed again with success as Chairman of the Nominating Committee by presenting our new president, *Lorraine Blondes Shapiro '42* with a fine slate of supporting officers and directors.

Fund raising was an integral part of the year's activities. Chairmen for the Annual Giving Program were *Eileen MacElarney '53*, *G '56* and *Lorraine Blondes Shapiro '42*.

Through their enthusiasm a substantial gain in alumnae participation was realized. We are represented in the Lesley College Building Program planning by *Polly Wilson Connell '26* and *Mary McCarron Mead '25*.

In my opening message to you last year, it was my privilege to announce the appointment of Miss Catherine Ham as Director of Alumnae Relations. I find myself in just the reverse situation for my final report. Miss Ham has left under the same pleasant circumstances as her predecessor. Catherine was married to Dr. Anthony Bryan Moore of Miami, Florida in August. The Moores will reside in Amherst. We extend to them our best wishes for happiness and success. Catherine's departure is a great loss to us since she has executed her role as Director of Alumnae Relations with a charming, pleasant manner, thorough organization and true dedication. It is due, in large part, to her continued work that the Association has advanced smoothly and successfully during my term.

The most exciting piece of news, I have saved until the end in hopes that it will thrill all alumnae as it did the Board of Directors. It gives me great pleasure to announce that a new Faculty-Alumnae Club is programmed for the second phase of Lesley's building program. In the projected plan, the Alumnae Lounge will reflect the history of Lesley in decor and atmosphere, and will include the portraits and artifacts recalling Lesley's past. In order to realize this plan, the Alumnae Board has agreed unanimously to support the College in its efforts on the forthcoming Capital Campaign.

In conclusion, I wish to thank each and every one of you for your support and participation during the year 1968-1969, and in particular, for the symbol of your appreciation of my services as President, the attractive Lesley chair presented to me at the Annual Association Meeting. I will thoroughly enjoy using it.

My best wishes to *Lorraine Blondes Shapiro '42* in her term in office and to the Alumnae Association as it continues to expand and define its image.



Introducing Lorraine B. Shapiro, Alumnae President, 1969-70

Lorraine Blondes Shapiro '42 always has felt close to Lesley College.

There are a number of reasons.

First, she felt that Lesley prepared her well for teaching nursery school and kindergarten for several years, until her marriage in 1947. Then, her sister, Evelyn Blondes Lamb, followed her as a student at Lesley, graduating in 1948. Now her own daughter, Deborah, is a Lesley Freshman.

Lorraine, a resident of Haverhill, has been active in the Merrimac Valley Alumnae Club for a number of years, and has served on the club's board of directors. She was a co-chairman of The Homecoming Dinner Dance for her 25th reunion in 1967. She was first elected to the board of the Alumnae Association in 1968-69 and served during the year as co-chairman of the highly successful Alumnae Annual Giving Program. Her nomination to the presidency was a natural step to follow.

Following the death of her husband in 1955, Lorraine entered a new career in the chemical business, as salesman for the American Finish and Chemical Company. Her interest in Lesley has never dimmed, however, and she has encouraged several girls to enroll in the College.

In addition to her Lesley activities, Lorraine has served in the Women's Division of Brandeis University, the Council of Jewish Women and Hadassah. She was president of the Haverhill Chapter of Hadassah for two years, and also served as a regional vice president.



Lorraine Blondes Shapiro '42

President, Lesley College Alumnae Association 1969-70

Many said it would never happen, but it is happening!

This IS the year when the new campus building program gets under way. As you may read elsewhere in this publication, about \$3 million has been raised from government and private sources to start the First Phase construction, leaving only about \$1 million yet to be pledged, mostly from individuals. The target date for ground-breaking is Spring of 1970.

What does this mean to the Alumnae Association? Through the resolution passed by your board last January, we already have pledged to assist the efforts of the college's Board of Trustees to make the campus dream a reality. Now that the Trustees have largely done their part to bring the Building Program this far, the onus is partly on us to give the back-up they need.

Certainly, we alumnae are not expected to raise all the additional money needed to build the campus. But we certainly are expected to raise a realistic piece of it through a combination of fund-raising and public relations activities.

I think our mission is clear. We must direct our association programs — those already established and those that may be developed — so that they may meaningfully contribute to the goal that has been set for the College this year.

Personally, I believe we have a strong board and proven leadership for the task ahead, and I want to thank those who are returning to the board and the new members for joining the team. We have some high standards to live up to, and a challenging objective.

If we are to be successful (and I'm sure we will be), this is the year we all must display our loyalty to Lesley and our pride in its accomplishments. Our College has grown tremendously in size and stature, and we as an alumnae organization must continue to grow with it.

I would like to see many new faces on our committees and attending our programs. This is the year for more active participation — don't wait to be asked, let us know your interest. This is the year, also, to hear from everyone with their suggestions and ideas. Don't hesitate to call on me or any of the board members.

With your interest, support and involvement, I know that this will be a great year for our College and our Alumnae Association. I look forward to working with each and every one of you.

Club Notes

BROOKLINE - NEWTON

"Lesleyites" from the Brookline-Newton area welcomed spring at their annual luncheon in May. The Pillar House Restaurant provided a lovely setting for the event. To top off a delicious meal, Virginia Tashjian, librarian for the Newton Public Library, reviewed several of the latest offerings from the literary world. Everyone enjoyed her presentation and went home armed with "musts" for their reading lists. Committee members were *Barbara Paul Holzman* and *Barbara Barron Schilling*. The winter meeting was held in February at Chestnut Hill and featured a lively presentation by Susan Rutstein and Bunny Freedman of "The Black Velvet Cushion." *Carol Kenter Papermaster* served on the committee with *Barbara Schilling* and *Barbara Holzman*.

CENTRAL MIDDLESEX

The newly formed Central Middlesex Club had its first meeting at the Sheraton-Lexington Motor Inn in April. A delightful luncheon was served followed by a demonstration and talk by Mrs. Desyle S. Schmedes on making party decorations and paper flowers. At the conclusion of the program, four of Mrs. Schmedes' flowers were auctioned with the proceeds earmarked for the Alumnae Scholarship Fund. Committee members were *Gail Roberts Dusseault*, *Eileen O'Leary O'Laughlin*, *Mary McCarron Mead* and *Geraldine Nye Pedrini*.

MERRIMACK VALLEY

The winter meeting was held in January at the Lanam Club in Andover. During a cocktail hour preceding the luncheon, a "Sock it to Me" grab bag brought donations for the club's \$50 contribution to the Scholarship Fund. Dr. Boris Gertz, Director of Lesley's Graduate Program, spoke to the group about "T-group Experience and Human Relations Training," an approach being used by Education, Business and Industry in seeking ways in which people can work more effectively with each other.

NORFOLK COUNTY

Lesley Alumnae met at the home of *Frederika Van Vleck Cox* in April for dessert and coffee. Special guest was Don A. Orton, who outlined the proposed plans for the new campus and showed slides of the architect's renderings of what is to become the new Lesley College. Area towns and their representatives included in this club are: Dedham, *Patricia McHugh Ford*; Dover-Westwood, *Frederika Van Vleck Cox*; Needham, *Marcia Kilsky Traub*; Wellesley, *Barbara Yarlott Liepmann*; Weston, *Carol Crockett Everett*.

NORTH SHORE

The "Ship", on Rt. 1, hosted a March meeting of the North Shore Alumnae and their husbands. Everyone enjoyed a mouth-watering meal, jovial company and an interesting slide presentation of Lesley's new campus. Accompanying the guest speaker, Mr. F. Weston Prior, Vice President for Development at Lesley College, were Catherine Ham, Alumnae Director, and Mrs. *Jane Bailey '68*, a Lesley Alumna involved in pre-capital campaign planning. *Marilyn English Riley '59*, was Program Chairman of the evening. The November meeting was held in the home of *Marjorie Stern*, whose husband, Henderson, presented a film set to music of the Stern's travels in Europe. It was a most enjoyable evening for all.

SAN FRANCISCO AND BAY AREA CALIFORNIA

A May luncheon was held at the delightful "Allied Arts" in Menlo Park. Wonderful food, beautiful gardens, smart decor and most unusual gifts combined to create a marvelous experience for more than 20 Alumnae. The College expresses special thanks to members of the San Francisco and Bay Area Club for their lovely book entitled "Unofficial Art in the Soviet Union." It is a welcome addition to the library and the autograph of its author, Igor Mead, is appreciated. Dr. Don A. Orton visited the California area during the months of March and April. Informal evenings were pre-arranged in order to introduce Alumnae to Lesley's planned "urban academic village" and the educational philosophy behind it.

SOUTH SHORE

The first meeting of the newly reorganized Lesley College South Shore Alumnae Club was held in April at the Charterhouse Restaurant in Braintree. *Benita Crosby Goldman '61*, co-chairman of the dinner meeting, introduced the head table guests. They were: *Dolores Glasser Orkin '63*, Acting Secretary of the South Shore Club; *Joyce Marshall Snyder '61*, Secretary of the Lesley College Alumnae Association; *Roberta Caras Fishman '61*, co-chairman of the evening; Catherine Ham, Director of Alumnae Affairs; and Mr. F. Weston Prior, Vice President of Development at Lesley. Mr. Prior made an informative and interesting presentation on development of the new campus. More than twenty-five Alumnae were in attendance and all of them were looking forward to the next meeting, to be held this Fall.



WORCESTER

The Worcester Club had a very active year. A Spring Luncheon was held in April at the Mount Pleasant Country Club in West Boylston, and *Janet M. Silva '58*, then President of the Alumnae Association, spoke about Lesley's current goals and programs. A Project Meeting was hosted by *Nancy Gore Goff '65* and *Caryl Marone Masiello '57* in February. Money realized from the evening was used for the Scholarship Fund. In January a Social Board Meeting was held at the home of Club President, *Barbara Goldy*. A birthday party was held in October to celebrate the Worcester Club's 5th birthday. At that time officers for the coming year were installed.

Class Notes

1920

Adele Gruener has weathered the throes of moving and is now settled at 24 Patten Street in Watertown.

1921

Sympathies are extended to the family of Marion Smith Linehan, resident of Cambridge and former teacher in the Arlington Schools, who passed away this past January.

1922

Mary B. Warren who passed away recently, bequeathed a sum of \$1,000 to Lesley to be used towards the new campus.

1923

Sympathies are extended to the family of Mary J. Breslin of Fall River who passed away in March.

The College has been informed of the death of Anna Rooney Hackett, formerly of the University of Maine, where she had been serving as house mother. Previously, Anna had taught in the Orono, Me. schools for six years.

1925

Betty Brown Bliven and her husband, of New Jersey, are enjoying their retirement. She taught in the Morris Township School System. Their son, Stephen, graduated from Brown University and is presently with the U.S. Army in Europe. Daughter, Kathleen, was graduated from Fairleigh Dickenson University and now teaches second grade in the Morris Township School System.

Congratulations to Sara Rubin Cohen, Secretary of the North Shore Alumnae Club. She will be serving as representative for her area on the Alumnae Association Nominating Committee for the coming year.

The College was saddened to learn of the recent death of Ada Bangs Fayle, a native of Machias, Me.

Mary McCarron Mead is continuing her good work as a member of the Alumnae Board of Directors and is also heading up the alumnae phase of the Capital Campaign.

1926

Helen Ewing Holmes retired from her private kindergarten in May but plans to remain active as a substitute teacher in the Stoughton Public Schools.

1927

Best wishes to Gail Sanford Gerds and Ramono Clark Abbe on their marriage. The Abbes plan to make their home at "Villa Vista Abbe-Gail" in Enfield, Conn.

1930

The Class of '30 seems to be an elusive group. Let's hear from: Helen Newhoff Barrish, Marion Bucheit, Harriet Bates Bunker, Catherine Mahoney Garvey, Carolyn Moody Horner, Katherine White Kibbe, and other "thirtiers."

1934

Now teaching second grade in the Harris M. Dolbeare School in Wakefield, Mildred Billings Clarke recently completed 30 hours in addition to her Master's Degree.

1938

Best wishes to Helen T. Brooks, married to Mr. Edward S. Doherty, Jr. last winter. Her husband is an administrator of the Baseball Umpires Development Association. The Dohertys will make their home in St. Petersburg, Fla.

1939

Congratulations to Myrtle Peirce Aulenback, who will serve this year on the Association Nominating Committee.

Marion Macomber Fitzsimmons, currently living in St. Louis, Mo., has five daughters and a son. One of the girls, like her mother, is a teacher.

Congratulations to Eileen O'Leary O'Loughlin whose daughter, Anne Marie Chenette, graduated from Lesley in June.

1940

Beatrice Marden Glickman, Past President of the Alumnae Association, revisited Lesley this fall in a professional capacity. As director of a Framingham Kindergarten, Bea was a natural resource person for "Up the Down Staircase," a Continuing Education program which provided an opportunity for Lesley Alumnae and students to discuss teaching in the various school systems of Massachusetts.

1946

Joining her colleagues from the Kindergarten Division of the Glover School in Marblehead, Marjorie Curtis Cole participated in a November 7 program entitled "Preparing Your Child for School," sponsored by Parentcraft of Essex County.

1950

Our deep appreciation is extended to Marguerite Shamon Delany, who will again be serving on the Board of Directors. Marguerite deserves special mention for her expert management of Association funds in her position as Treasurer for the past two years.

Moving into the role of 1st Vice-President for the coming year is Barbara Barron Schilling. Barbara's abilities have been well demonstrated in the Brookline-Newton Club and we're sure that the Executive Council is the richer for her presence.

Shirley Marchant Lindgren represented Lesley College for Dr. Orton at the inauguration of Dr. John J. Pruis of Ball State University, Muncie, Ind. in April. The Lindgrens reside in Aurora, Ind.

1952

Best wishes to Joan Cross, married to Paul A. MacQuade last summer. Joan and Paul teach at the Horace Mann School in Melrose.

An active member of the Central Middlesex Club, Anne Struik Macchi, will represent her area on the Association Nominating Committee this year. Anne and her husband, Robert, live in Arlington.

Jean Cogan McKeon, who recently returned from a trip to South America, will serve again this year on the Board of Directors. Special thanks go to Jean for her fine job as President pro-tem during the early winter months, and for her assistance as Vice-President for the year 1968-1969.

1953

Barbara Ann Cushing married Richard L. Hoffman in Southington, Conn. The Hoffmans plan to settle in Wallingford at 9 Segwin Circle.

The College extends its sympathies to the family of Doris MacGregor Henderson, who passed away in March after a long illness.

After an initiation to Association activities through her work as Co-chairman of the Annual Giving Fund, Eileen MacElarney will join the Board of Directors in the fall.

Janice M. Ryan married Richard L. Plas last summer. They now live in Mayfield, Ohio.

1954

As a member of the Kindergarten faculty of the Glover School in Marblehead, Irma Schulkin Goldstein participated in a November 7 program entitled "Preparing Your Child for School." Irma teaches the accelerated class at the Glover School.

Jane DiTiberio Johnson of Plainville, Conn., has been acting in summer stock from Kennebunkport, Me. to Mt. Southington, Conn.

Della MacAskill Schultz writes that her husband's new position as Senior Minister of Christ Church Congregational will take them from Auburn, Mass. to Glastonbury, Conn. where the church is situated. Della also reports that she is contemplating entering a Master's program.

1955

Hospital volunteer work and organizational involvement are keeping Carole Spill Berman of Auburn, Me. constantly on the go. Carole's youngsters, Beth and Susan, are both in school now: the former as a second grader and the latter in nursery school.

Polly Monroe Furbush joined other reading specialists at Lesley College in December at "Up the Down Staircase Night." She is presently on educational leave from the Wellesley Public Schools and will be a Doctoral Fellow at Boston University for 1969-70.

Joining the Lesley Alumnae Association Board of Directors in the fall of 1969 will be Winifred Linehan, a Cambridge

resident and alumnae of Lesley's Graduate School. Miss Linehan is a member of the New England Kindergarten Conference Steering Committee and Director of Primary Grades and Kindergarten for the Cambridge Schools.

1956

On hand for "Up the Down Staircase Night" was Mary V. Wright, Education Director of the Cambridge Child Development Program for Early Childhood.

1957

Ann McCann and Richard L. Magaletta were married last summer and are living in Framingham.

1958

Judie Higgins Johnson wrote enthusiastically about her memories of the 10th reunion and noted that her two children, Heather and Holly, are in third grade and kindergarten.

1959

Congratulations to Barbara Harrison Dine and her husband, Philip, on the birth of their daughter, Andrea Beth, last September. The Dines are currently living in Liverpool, N.Y.

Congratulations to Marilyn English Riley, who will serve as Treasurer of the Alumnae Association during the coming year.

1960

Gail Roberts Dusseault, of Belmont, was actively involved in the programs of the Association this past year, particularly in planning for "Up the Down Staircase Night." She also chaired the "Step-up Night" Committee.

Dede Sharp Hadelman has expressed her thanks to fellow classmates who have faithfully served on the 1960 Annual Alumnae Giving Committee. A warm THANK YOU to:

Marcia Juliano Abale
Sheila Brickman Byers
Joyce Leonard DeGrigero
Gail Roberts Dusseault
Joyce Jackson Fox
Paula Rozomofsky Horn
Sandra Freshman Keller
Barbara Goldman Packer
Joyce Karp Rosenthal
Carol Scipione Voci
Elaine Zucker Wax

Dede is now making her home at: 318 East Sunset Drive, North Redlands, Calif.

Joslyn Hills Kirkegaard and her family are living in a suburb west of Chicago, where they find Midwesterners to be warm and Chicago to be exciting. The Kirkegaards have three children: Dana, 5; Eric, 3; and Brad, 10 months. Joslyn is still active as a remedial education teacher.

Rae Dinner Seife, a four-year resident of Binghamton, N.Y., tells us that she and her husband, Irwin, have two children: Jeffrey, 5; and Deborah, 6. Irwin is Chief Radiologist at Binghamton General Hospital. Rae would like to hear from some of her friends.

1961

Joan Sorkin Dretler is the mother of three boys: Jeffrey, 5; Danny, 2½; Tommy, 4 months. Her husband, Steve, is presently a Resident in Urology at Massachusetts General Hospital and they are living in a brand new home on 18 White Road in Wayland.

Congratulations to Della Rose Gilman and her husband, Ira, on the birth of their daughter, Jodi Ellen, in March.

Joyce Marshall Snyder has contributed to the success of several Association programs this past year, especially her work on "Up the Down Staircase Night" and the Tony Saletan Presentation "Sing, Children, Sing." Joyce is currently the Secretary of the Alumnae Board and will serve in this capacity during 1969-1970.

1962

Linda Kane Edgar writes, "Bill and I have fraternal 'red-headed' twin boys born to us January 1, 1968." The Edgars enjoy the pleasures and challenges of parenthood and report that they are happy in their new home in Burlington.

Marjorie MacKay Fleming now makes her home in Wadsworth, Ohio. She has three children, ages 6, 4, and 2. The Flemings are living at 357 Tolbert Street.

A note from Susan Harlow Howe tells us that she and her husband, Bill, are the very happy parents of a very talkative daughter, Jennifer, and a lively little boy named Andrew. The Howes make their home in Alexandria, Va.

Bridget Lacy joined the family of Marian Horvath McGee and her husband, Bill, in April. Congratulations.

Judith Rosen Rothenberg, a sixth grade teacher in the Brookline School System, served as a resource person for "Up the Down Staircase Night" in December.

1963

Marilyn Saltz Bernheimer tells us of West Coast-East Coast swing. After graduation, she and husband, Lenny, moved to Palo Alto, Calif., where he studied for his M.B.A. at Stanford Business School and she taught fourth graders in Redwood City. The Bernheimers and their children have now returned to this area and are residing in Natick, at 14 Pauline Drive.

Congratulation to Dolores Glasser Orkin and husband, Don, on the February arrival of Laura Susan Orkin. The Orkins have two other children: Jeffrey Scott, age 4 and Lisa Beth, age 3. Dolores still manages to be "where the action is" through tutoring and involvement in the newly formed South Shore Alumnae Club.

Last December brought a new addition to the family of Geraldine Nye Pedrini and her husband. A little baby boy named Richard Ralph Jr. is now keeping Gerry on the go. Gerry will be serving on the Association Nominating Committee for the coming year.

Linda Leveton Radding and husband, Ed, who is Media Director for Gillette Toiletries of Boston, are now living in a new home in the Framingham area. The Raddings have a 2½ yr. old daughter, Jennifer.

Representing the special area of teaching perceptually handicapped, H. Leslie Walmsley, from the Burlington School System, was on hand for "Up the Down Staircase Night."

1964

Joyce Finkelstein writes that she enjoys keeping up with Lesley's progress via the "Review." After two years of teaching with the U.S. Government in Weisbaden, Germany, she plans to transfer to Japan, "in order to see more of the world and be exposed to a new culture."

Diana Schaffer Lewinstein reports that, "the past five years have been hectic and eventful ones. After a year of teaching and obtaining a Master's Degree from Columbia University's Teachers College, I was married to Stephen R. Lewinstein. I then taught another two years while my husband completed law school and a year's clerkship in the Rhode Island Supreme Court. Steve is now Assistant to the President of Barclay Limited in Boston while I am acting as Consultant for the Emotionally Disturbed in the State Department of Education in Rhode Island."

Joining another alumna of the "sixties", Judith Diggs Potter came back to Lesley in December to represent the kindergarten branch of the Boston School System at "Up the Down Staircase Night." Judy is now living at 1 Brooke Street, in Brookline.

Best wishes to Shirley Silbovitz and Robert L. Finkelstein who were married in May.

Susan Golden Tannor informs us that she and husband, Richard, are presently living in Hempstead, N.Y.; and that after 4½ years of teaching she has "retired" to become a full-time mother to her baby, Caren Lynn, born last February.

A line from Linda Hecht Tunkel reveals that she is now the mother of a baby girl, Elaine Lisa, in December, 1968. Her husband is working as a systems engineer for RCA in Hartford where the Tunkels are residing at 21 Bell Court.

An Alumna of Lesley's Graduate School, Mrs. Doreen Wilkinson is currently "head teacher" (principal) of the Roxbury Community School. Describing the school, Dr. Joseph Yokelson of Sharon has stated, "It is a vital educational experiment . . . one which could contribute much to established schools all over the country." Our best wishes, Doreen, for continued success.

1965

Congratulations to Judith Ann Dunn who became Mrs. Arthur W. Graham last May. Judy and her husband, an end on the Boston Patriots' line, are residing at 218 Wachusett Avenue, Arlington.

Nancy Gore Goff, President of Worcester Country Club for 1967-1968, will serve on the Nominating Committee for the coming year.

Beverly Siskind Kahn and her husband Robert, who is associated with the Wall Street brokerage firm of McDonnell & Co., had a son, Laurence Stuart, last December. The Kahns make their home at 178-10 Wexford Terrace, Jamaica Estates, N.Y.

Presently teaching reading in Grade 1 of the Malden Public School System, Elizabeth B. Klaiman, an alumna of the Graduate School, came back to Lesley for "Up the Down Staircase Night."

Gloria Knell writes that in August, 1968, she married Bernard Magliozzi, a '65 graduate of M.I.T. After a Bermuda honeymoon, Gloria returned to her second grade class in Winsted, Conn., and her husband to his position as an aeronautical engineer at Hamilton Standard. The matron of honor, Carol Brainerd Roberts, came all the way from Arizona to be on hand for the wedding ceremony. The Magliozzis make their home at 1083 Blue Hill Ave., Apt. J, Bloomfield, Conn.

Gayle E. MacDonald, who has been working with New England Telephone since 1966, has recently been appointed staff instructor in Quincy.

Nancy Joanne Mellen became the bride of Joseph Meehan, Jr., in July. The Meehans will live in Lowell.

Carol Brainerd Roberts informs us that she and her husband, who have been living in Scottsdale, Ariz. for the past three and one half years, have recently moved to N.H., where Steve is working as an electrical engineer. The Roberts have two children: a 20 month old daughter, Becky, and a new baby born in May.

Congratulations to Harriet Salk Simon and her husband, Robert, on the birth of their new son, Douglas Eric last October.

1966

"Sixty-sixers" arrived en masse to participate in "Up the Down Staircase Night" in December. Included in this junior-sized reunion were: Nancy E. Bogg of Newton, Patricia Devlin of Woburn, Joanne Lipscher Goodman of Norwood, Judith Kaye Haas of Newton, Barbara Hafner of Medford, and Louise G. Weston of Newton.

Marilyn Sargon Brier completed her Master's in Social Work at B.U. and is a social worker at St. Vincent Hospital in Worcester. Her husband, Michael, is studying for his Ph.D. in Physics at Worcester Polytechnic Institute. Their address is 61 N. Ashland Street, Worcester.

Diana Cavallo is teaching this year in North Reading.

Shirley Culgin became Mrs. John E. Drury, Jr. in Cranston, R.I. last December. Shirley is currently living with her parents in Cranston until her husband completes helicopter pilot school and does his tour of duty in Vietnam with the Army. A fourth grade class in Johnston, R.I. occupies her spare moments in the meantime.

Congratulations to Joanne Lipscher Goodman who will serve on Lesley's Association Board of Directors this year. Joanne and husband, William, are living at 25 Custer Street, Jamaica Plain.

Jane Atwater Hale reports that she was married in August, 1968 "to Bob, the same 'Bob' I was going with all through Lesley." The Hales have bought a home in Duxbury and are living at 221 Summer Street. Jane is teaching second grade in Hingham and "still loving it!"

Last year Joan Wilson — now Joan Wilson Hobbs — was married in Venezuela. She spent the year teaching brain damaged children in the Caracas Study School. During a severe earthquake, she met her husband to be, David, a Peace Corpsman. The Hobbs are presently both attending North Texas University. Joan is teaching first grade and working on her Master's in counseling. In addition, Joan and David raise and breed "Mucuchies," the national dog of Venezuela.

Married during the spring and summer were Celeste Amenta to Lorenz John Jinison; Susan Briggs to Edward James Sylvia; Eileen Beth Cutler to Jay Harlan Espovich. Also married were Barbara Marie Hafner to Shaun Quinlan, and Mary Walp to Thomas L. Stripling.

Upon receiving an M. Ed. degree in January, 1969, Jayme Sicherman Horowitz resumed teaching a special class for children with learning disabilities. Jayme's husband, Stephen, is employed as supervisory principal in Merrimack Valley School District and the Horowitzes reside at 345 Kennard Road, Manchester.

1967

Ellen Herwitt Atkins announces the birth of a daughter, Rachel Stephanie, on September 11, 1968. The Atkins family make their home at 53 Sacramento Street, Cambridge.

Joining Pamela Baughman, a grade three teacher in Chelmsford, at "Up the Down Staircase Night" were Marilyn Beach of the Graduate School, a mental Health specialist working in the Community Clinical Nursery School Program, and Margaret O'Neill Ywoskus, who is a representative of Headstart.

Congratulations to Marilyn Beach who will serve again as 2nd Vice-President of the Alumnae Association, in 1969-1970.

Best wishes to Susan L. Clarke and John J. Hughes, Jacqueline Ann Hart and Richard E. Leach and Janet Lipman and John Brennan.

Marjorie Daner, who received her Master's Degree in 1967, was married to Dr. Thomas A. G. Sos in July.

A note from Ellen Smith Klein reveals that she is teaching second grade in the Colonial School District and working towards her M.A. at Temple University. Her husband, Richard, is a third year graduate student in the Ph.D. program for Electrical Engineering at Penn. State. Ellen would be delighted to hear from Lesley alumnae in the Philadelphia area.

Susan Tendler Kotlen writes that she and husband, Jay, have moved to N.J. Jay is working for Allied Chemical in N.Y. City and their new address is 181 Meriline Avenue, West Paterson.

Gail Nardus has been elected to Pi Lambda Theta at B.U. where she is doing graduate work in remedial reading. She will receive her Master's Degree in December.

Best wishes to Carol Mills Paige and her husband, David, as they make their new home at 14 Enon Street, Beverly. Carol is presently substitute teaching in the Beverly School System.

Rosemary Ilvento Penta writes that she is teaching sixth grade in North Bergen, N.J. Her husband, Carmen, is employed by Price Waterhouse of N.Y. City. The Pentas live at 6010 Boulevard East, West New York, N.J.

1968

A letter from Carolyn Bourne informs us that she is teaching a special class in Duxbury and is engaged to Charles Kronengold, a B.U. graduate and student at New Jersey College of Medicine.

Susan Corcoran, of Norwood, taught in North Reading this past year.

M. Christine Cross was appointed to the faculty of the Mary C. Burke School in the fall of 1968. Christine is working in the kindergarten division.

Surrey Sherman Hardcastle and husband, Hugh, announce the birth of Yellot Fitzhugh Hardcastle, IV in December, 1968.

When Carole Ann Haskell married Kenneth Epstein in July, Annalee Tozier was one of her bridesmaids.

Judith Goldstein Horrigan became a "Mrs." in January. Judy and husband, Michael Horrigan, will be going to the University of New Hampshire in September where Michael will be taking his Master's in Business Administration.

Also married in July were Diane Hyman to Robert L. Gass, and Ruth Leslie Spritz to Theodore Grossman.

Alice Keefe was one of 31 trainees who graduated recently from a VISTA training program at the VISTA headquarters in New York. As a Volunteer in Service to America, Alice will spend one year working with the Summerset Community Action Program, in Somerville, N.J. Her activities will include counseling and recreational activities, including the YMCA, tutoring; and job referrals.

Sherrill Roberts Mariani and her husband make their home in Storrs, Conn. They now have two sons: Scott Ralph, two years old and Albert S. Jr., 8 months old.

Deborah Slater Meyers reports that she and husband, Herbert, are living in Belmont, at 8 Linden Ave. Deborah is presently teaching kindergarten in the Cambridge School System.

On February 1, 1969, Ilene Meyer became Mrs. Jack L. Shapiro. The Shapiros are living in Virginia Beach, Va. where Jack is an area sales manager for Scott Paper Company. Ilene warmly writes that "anyone ever in the area is perfectly welcome to visit us." Their home is at 207 65th Street.

Cheryl Post writes that she married James Slater in July, 1968. While Jim is studying at New York Medical College, Cheryl keeps busy teaching 2nd grade in Teaneck. They now live at 2160 Center Avenue, Fort Lee, N.J.

1969

Janice Sarno Doran is teaching in Medford this year; Paula Trager in Malden, and Susan Haveson in Millis. Margaret Lynch is teaching Grade 3 in South Easton, Karen Minsinger is teaching in Milton, Linda Rothbaum is teaching in Chelmsford, and Linda Wickeri is teaching in Oxford.

During the summer Judith Peirce helped run a Day Care Center in Somerset.

Many recent graduates were married during the summer. Among them are Arlene Susan Glaser to Michael Ira Sobol; Linda R. Greenberg to Stephen D. Desatnik; Susan Jane Hill to Robert Leon Shell.

Also Carolanne McLaughlin married Lt. Daniel J. Donovan, U.S.A., and Faith Ackerman and Tobey Silberstein were bridesmaids for Carol Reissman when she married Richard Blum.

Jill Marjorie Swiatek married Edward B. Manning, and Dorothy Wolfe wed Gary Morton Welsh. Jane Ressequie and Barbara Granetz were bridesmaids for Susan Schwartz at her wedding to Joel R. Bloom.

Arleen Sher and Arthur Wein were married in July and are living in Cambridge.

PRICE AND INFORMATION

LESLEY COLLEGE CHAIRS

(New Prices Effective July 1, 1969)

Type-Chair	Basic Cost	Mass. Sales Tax	Total Cost**
Captain's			
Cherry Arms	\$43.00	\$1.38	\$44.38
Black Arms	42.00	1.36	43.36
Boston Rocker			
(Black Only)	33.50	1.03	34.53
Side Chair			
(Black Only)	26.00	.80	26.80

* Out-of-state residents are not required to pay Mass. Sales Tax. Mass. residents must add sales tax to basic cost in order to obtain total cost of each chair.

** Nominal shipping charges will be due upon delivery to destination. Chairs will be shipped directly from Gardner, Massachusetts. Allow two-four weeks for normal delivery.

Examples of Shipping Charges

Gardner, Mass. to:	Shipping Cost (approximate)
Boston	\$4.60
Worcester	4.35
New York	5.25



LESLEY COLLEGE CHAIR ORDER FORM

(Please Print) _____ Date of Order _____
 Person Making Order (Name) (Date)

 (Street)

 (City, State, Zip)
 Please order _____ Lesley College chair(s)
 Type: _____ Captain's Chair
 _____ Cherry Arms _____ Black Arms
 _____ Boston Rocker (Available in black only)
 _____ Side Chair (Available in black only)
 Ship to:

 (Name)

 (Street)

 (City, State, Zip Code)
 Enclosed is a check for \$ _____
 (Make checks payable to Lesley College Alumnae Association) This covers the cost of the chair (s) plus the Massachusetts Sales Tax if it is applicable.*
 Nominal shipping charges will be paid by the purchaser at the time of delivery.
 * Out-of-state residents are not subject to the Mass. Sales Tax. Mass. residents must include the sales tax in the total cost of each chair. See Price and Information Sheet.

MOVING OR CHANGING YOUR NAME?

To avoid missing a copy of Lesley Alumnae Review fill out form below and send to: Lesley Alumnae Review, 29 Everett Street, Cambridge, Mass. 02138.

Name _____ Year _____
FIRST MAIDEN MARRIED

Old Address _____
STREET CITY STATE ZIP

New Address _____
STREET CITY STATE ZIP

Husband's Name _____ Telephone _____

CLASS NOTES FORM

We are interested in hearing from more of you. Please send a note telling about yourself to Editor, Lesley Alumnae Review, 29 Everett Street, Cambridge, Mass. 02138. You have undoubtedly enjoyed reading about your classmates — they want to read about you also.

Name _____ Year _____

Address _____

Class _____ This is a Class Note _____

The Editorial Office of the Lesley Alumnae Review Welcomes Your Comments on Articles and Materials presented in each edition. Address your Letters in care of Editor, Lesley Alumnae Review, 29 Everett St., Cambridge, Mass. 02138.

The Lesley Alumnae Review is a publication of Lesley College, 29 Everett Street, Cambridge, Massachusetts 02138. Articles in the Lesley Alumnae Review are the express opinions of their authors and are not necessarily shared by Lesley College.

LESLEY COLLEGE
29 EVERETT STREET
CAMBRIDGE, MASS. 02138

NON-PROFIT ORG.
U. S. POSTAGE
PAID
BOSTON, MASS.
PERMIT NO. 20

ADDRESS CORRECTION REQUESTED
RETURN POSTAGE GUARANTEED

